

Installation, Operation and Maintenance Manual

Please read and save these instructions for future reference. Read carefully before attempting to assemble, install, operate or maintain the product described. Protect yourself and others by observing all safety information. Failure to comply with these instructions will result in voiding of the product warranty and may result in personal injury and/or property damage.

GRTC curbs are shipped in sections for field assembly. All required assembly hardware is provided. Attachment to roof or structural members and building weather protection are by others.

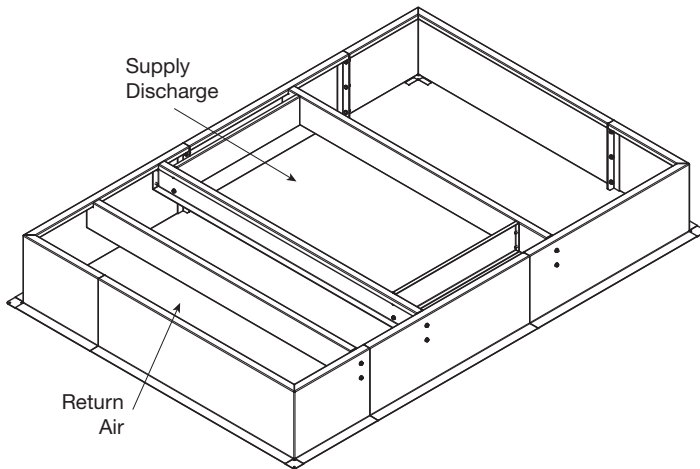

Fully Assembled Curb Dimensions		
Unit Size	Width (inches)	Length (inches)
100	35.86	85.86
200	54.84	94.48
300	64.90	94.50
400	78.80	124.90

* Dimensions do not include flashing flange

Curb Section Parts List				
Part	Description	QTY		
		Unit Size		
		100	200	300, 400
1	Front Right Corner	1	1	1
2	Front Left Corner	1	1	1
3	Rear Right Corner	1	1	1
4	Rear Left Corner	1	1	1
5	Right Middle	-	1	1
6	Left Middle	-	1	1
7	Return Air Cross Member	1	1	1
8	Front Supply Cross Member	1	1	1
9	Rear Supply Cross Member	1	1	1
10	Short Supply Cross Member	1	1	2

All parts are labeled from the factory for ease of identification

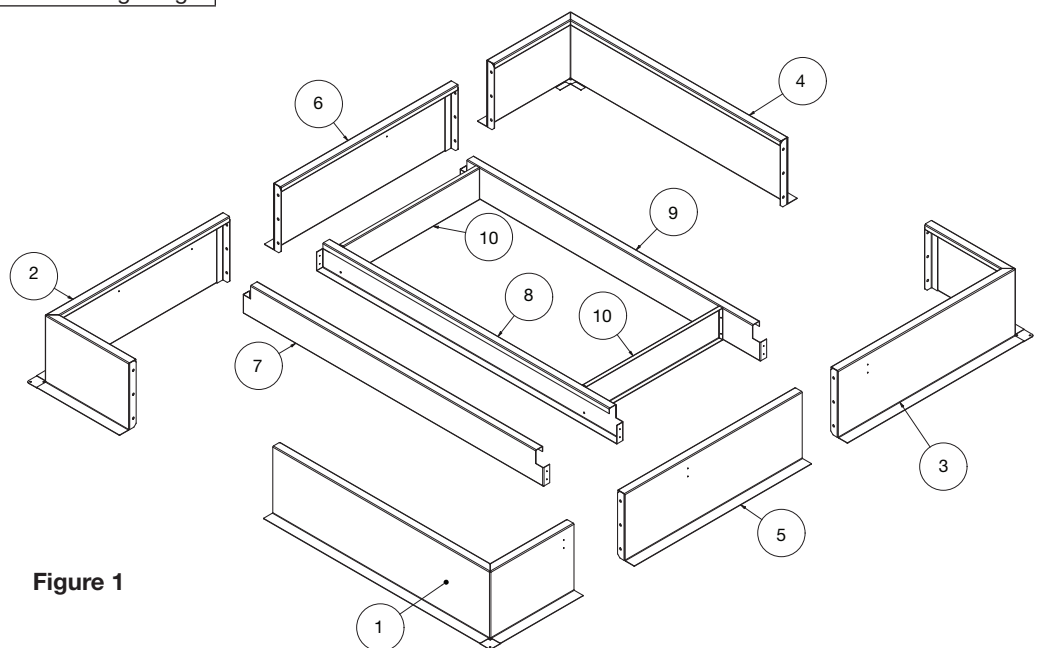

Figure 1

Included Hardware

All curbs are shipped with a hardware kit (part number 487268) including the following:

- 20 - SMS, #12-11X0.625"
- 18 - BOLT, 0.375"-16X0.75"
- 18 - NUT, 0.375"-16

NOTE

Insulation and wood nailer are optional and not shown in drawings. If ordered, each will be factory installed. These assembly instructions are valid for GRTC curbs with or without insulation or a wood nailer.

Assembly Instructions GRTC Curb

1. Identify the front right corner (part 1) and the front left corner (part 2). Fix them together using the nut/bolt combination. Repeat with rear right corner (part 3) and rear left corner (part 4). See Figure 2.
2. Identify the right and left middles (parts 5 & 6) and attach them to the front and rear sub assemblies using the nuts and bolts. See Figure 3. NOTE: Not required for size 100.

Figure 2

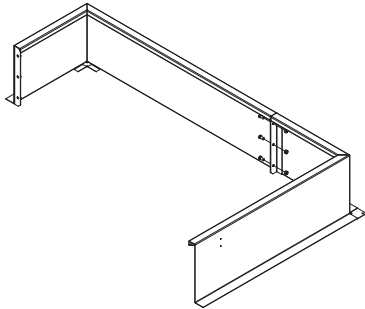
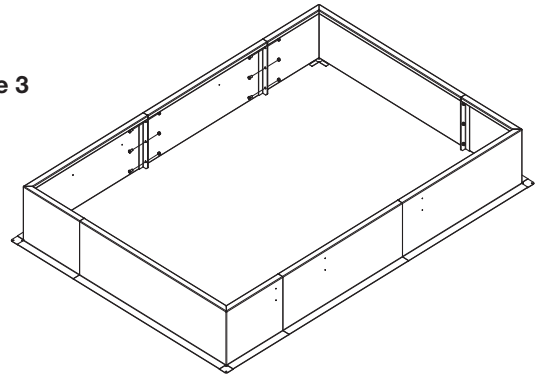

Figure 3



3. Identify the return air cross member (part 7) and place it inside the curb on the front. Fix it to the curb using the screws. The forms should face outward, away from the return air opening. See Figure 4.
4. Identify and place the front and rear supply discharge cross members (parts 8 & 9) using the screws. Ensure the forms are facing outward, away from the supply discharge opening. See Figure 5.

Figure 4

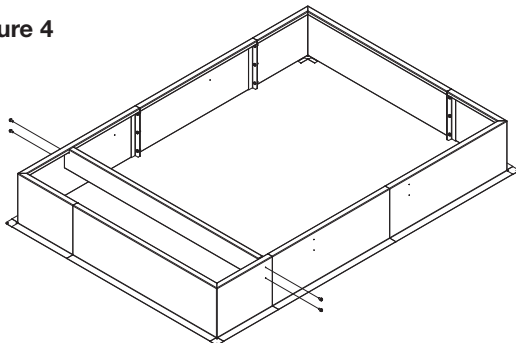
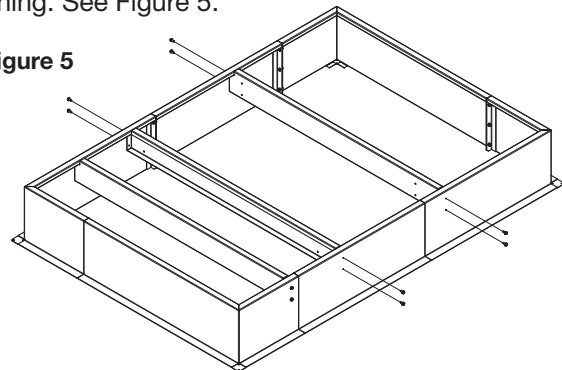
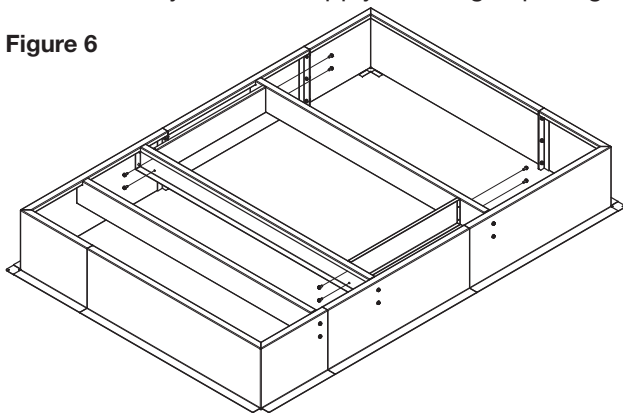

Figure 5



5. Identify the supply discharge short cross members (part 10, 1 piece size 100, 200; 2 pieces size 300, 400) and attach them to the front and rear supply discharge cross members using the screws. Ensure the forms are facing outward, away from the supply discharge opening. See Figure 6.

Figure 6



6. Finish by caulking perimeter seams and attaching the curb to the roof per local codes. The curb should be fully supported around its perimeter by the roof structure and securely fastened to the roof structure. Fasteners are by others.